

**GREENACRES ELEMENTARY SCHOOL**

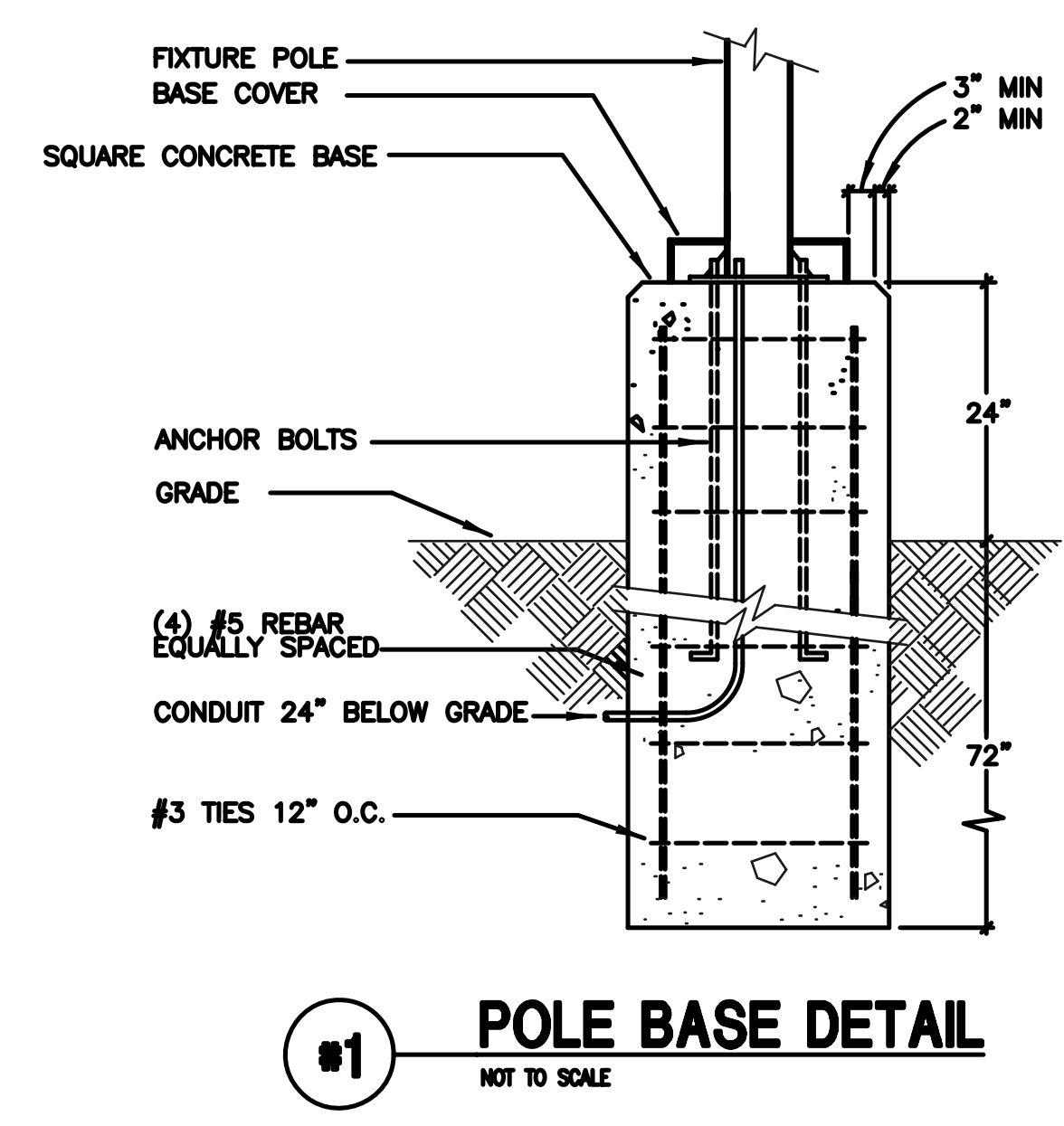

**GENERAL NOTES**

1. FIXTURE TYPE F1 SHALL BE SPAULDING #RCS-A-250H-3P-8-1-L-F1. POLE SHALL BE SPAULDING #SSS-XX-5-1-TA-DB. FIXTURES SHALL BE TENON MOUNTED ON TOP OF POLE TO MATCH EXISTING. PROVIDE POLE HEIGHT TO MATCH EXISTING. POLE HEIGHT SHALL BE VERIFIED ON SITE PRIOR TO BID. FIXTURES TO HAVE HOUSE-SIDE SHIELD.
2. ALL WIRING SHALL BE TYPE XHHW, STRANDED COPPER, 600V OR EQUIVALENT. CONDUIT SHALL BE SCHED. 40 PVC.
3. FIXTURES SHALL BE CONTROLLED VIA EXISTING TIMECLOCK DEVICE.
4. EXAMINE PREMISES AND BECOME FAMILIAR WITH EXISTING CONDITIONS AND INSTALLATION.
5. DRAWINGS ARE PARTLY DIAGRAMMATIC AND DO NOT NECESSARILY SHOW EXACT LOCATIONS OF ALL EQUIPMENT, DEVICES, FIXTURES, AND PANELS. CONTRACTOR SHALL FIELD VERIFY EXISTING CONDITIONS PRIOR TO BID AND START OF WORK. ALL DEVIATIONS FROM CONTRACT DOCUMENTS SHALL BE INDICATED ON AN AS-BUILT DRAWING SET.
6. SEE ARCHITECTURAL DRAWINGS FOR CONSTRUCTION PHASING OF THE WORK.
7. FIXTURES, LAMPS, AND BALLASTS REMOVED SHALL BECOME PROPERTY OF CENTRAL VALLEY SCHOOL DISTRICT UNLESS NOTED OTHERWISE.
8. PROVIDE ALL DEMOLITION WORK CALLED FOR OR REQUIRED BY THE INSTALLATION. REMOVE ALL EXISTING EQUIPMENT AND MATERIALS NOT REUSED UNLESS SPECIFIED OTHERWISE BY THE OWNER'S REPRESENTATIVE.

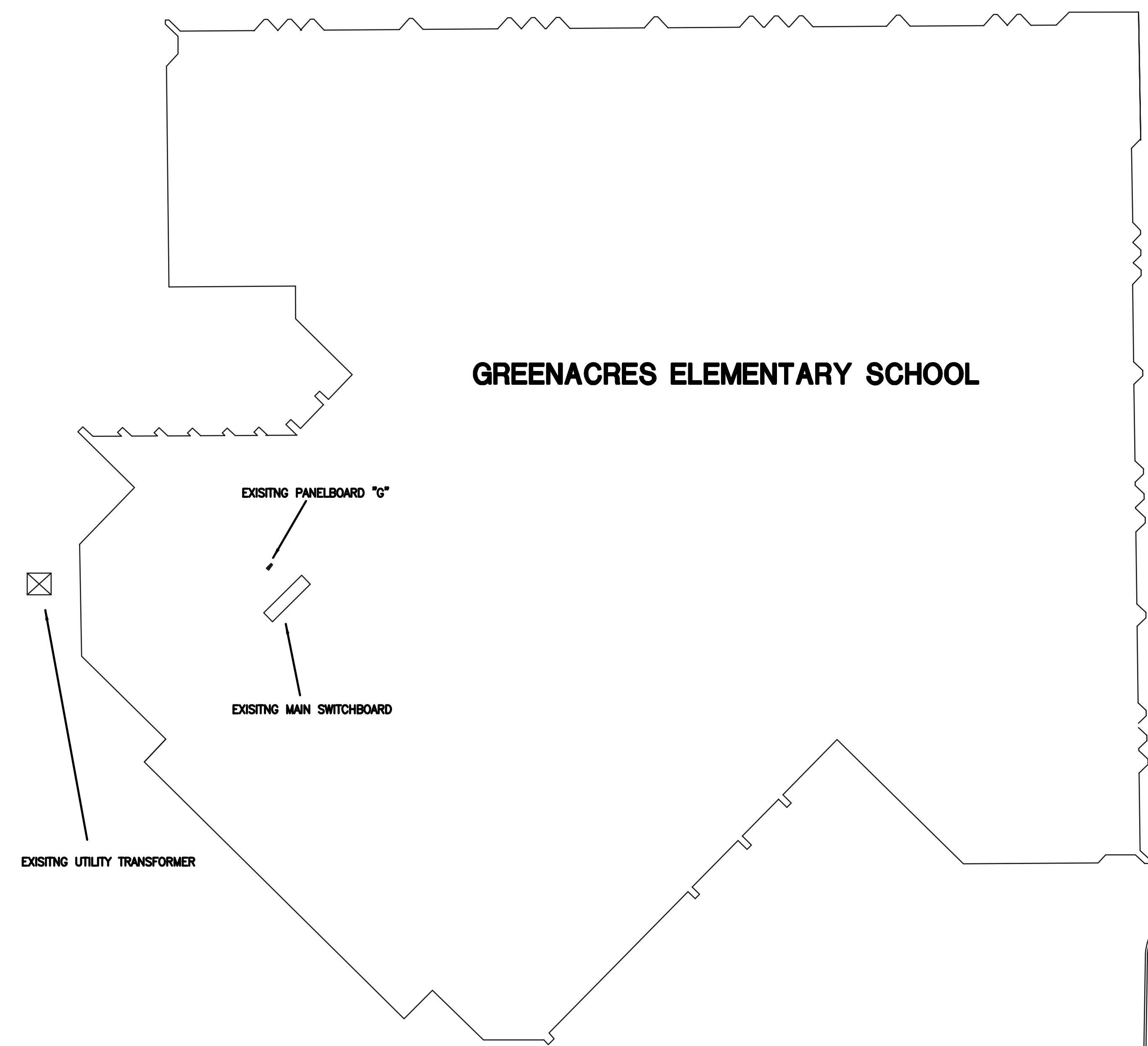
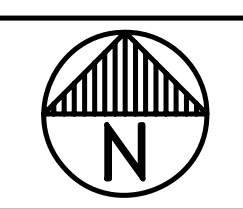
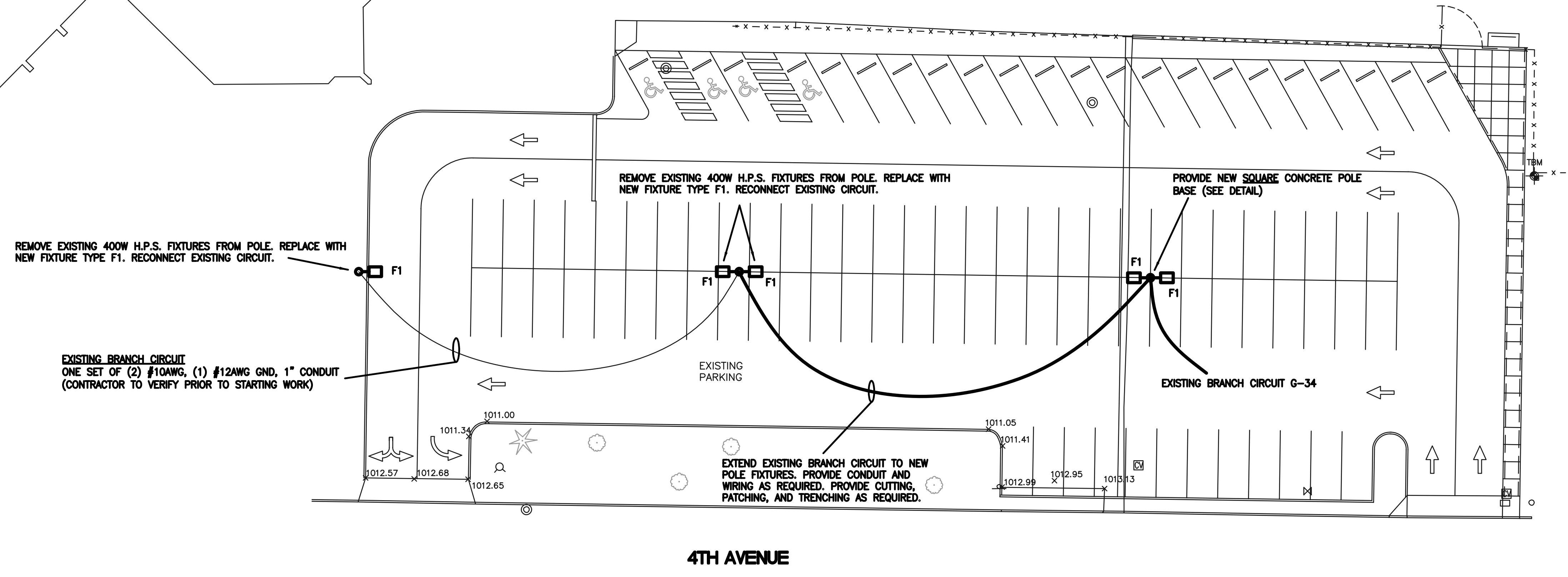

**SITE PLAN**  
 SCALE: 1" = 20'-0"